

Application of geopark for educational sector: ESD and SDGs

Katsuhiko ASAHI /Ph.D.

Izu Peninsula UNESCO Global Geopark,
Japan



UNESCO Global Geoparks

are single, unified geographical areas where sites and landscapes of **international geological significance** are managed with a holistic concept of **protection, education and sustainable development**. A UNESCO Global Geopark uses its geological heritage, **in connection with all other aspects of the area's natural and cultural heritage**, to enhance awareness and understanding of key issues facing society, such as using our Earth's resources sustainably, mitigating the effects of climate change and reducing the impact of natural disasters. By raising awareness of the importance of the area's geological heritage in history and society today, UNESCO Global Geoparks **give local people a sense of pride** in their region and strengthen their identification with the area. The creation of innovative local enterprises, new jobs and high quality training courses is stimulated as **new sources of revenue** are generated through **geotourism**, while the geological resources of the area are protected.

Main objection of geopark activities

Three pillars in geopark

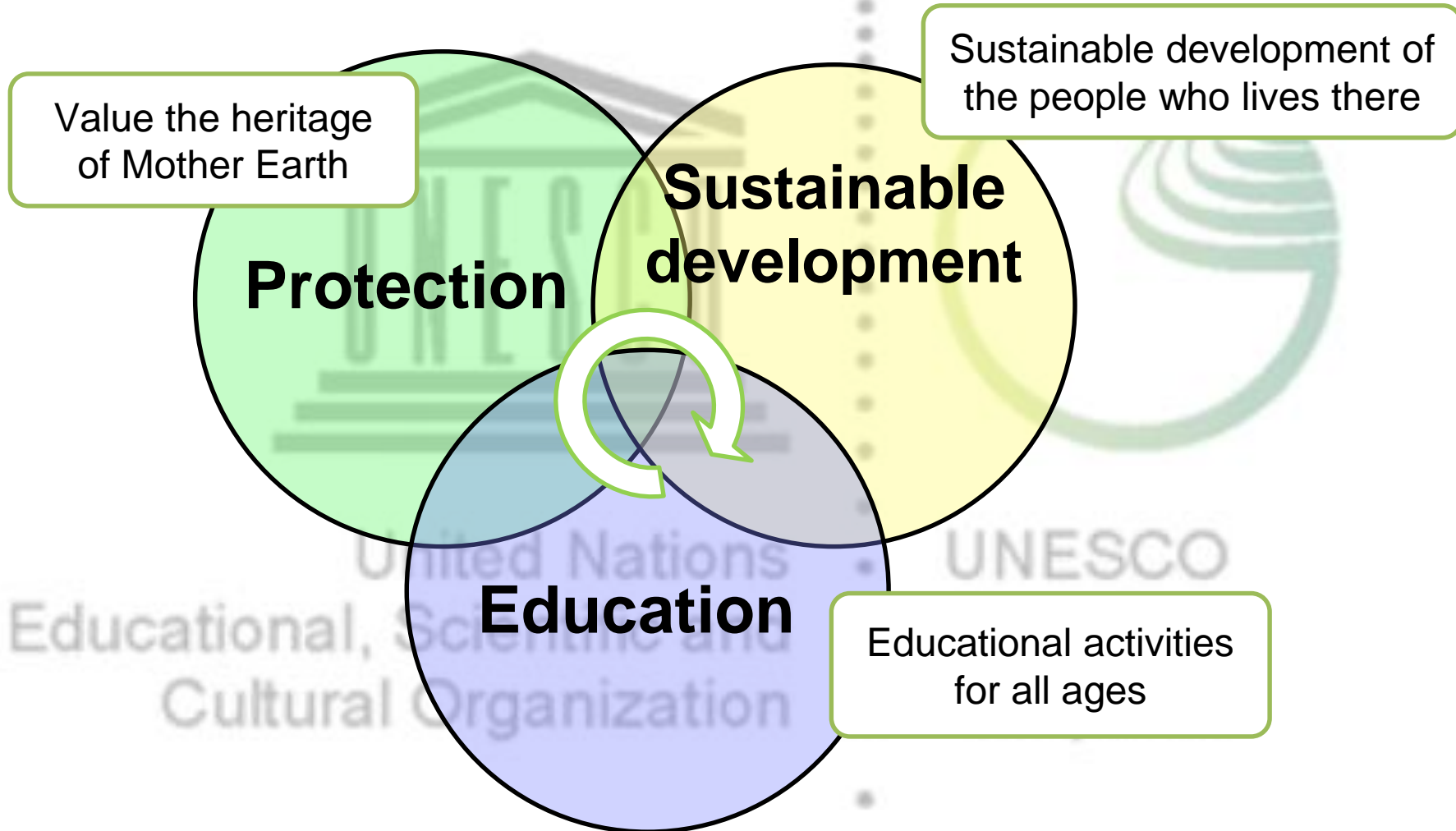

Education

It is a pre-requisite that all UNESCO Global Geoparks develop and operate educational activities for all ages to spread awareness of our geological heritage and its links to other aspects of our natural, cultural and intangible heritages. UNESCO Global Geoparks offer educational programs for schools or offer special activities for children through “Kids Clubs” or special “Fossil Fun Days”. UNESCO Global Geoparks also offer education, both formal and informal, for adults and retired people while many provide training for local people who can then, in turn, teach others.

Objectives of educational activities in geoparks

GGN (Global Geopark Network) Institutional Members need to develop strategies towards increasing access to education at all levels and increasing enrollment rates in schools particularly for female residents. In the respect of human diversity and local ethnic groups. GGN Institutional Members should give special attention to the adapted transmission of local culture and tradition and the transmission and survival of local languages.

GGN (2016) : Code of ethics



Expected educational activities in geoparks

- Research, information and education scientific activities in Earth sciences
- Programs operation of environmental education
- Development of educational materials
- Publication of information
- Geology provision for school groups
- Education by geopark guides
- Providing information to encourage school groups to visit
- School programs provided through the internet

Educational activities in Izu Peninsula UGGp

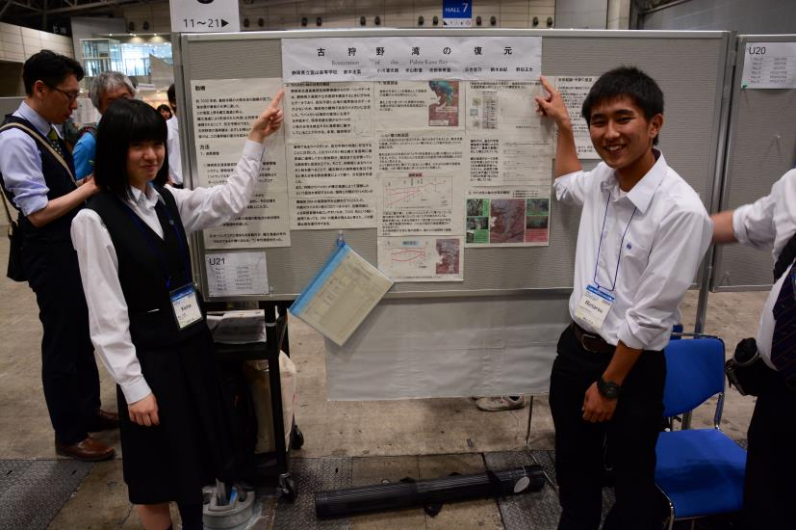

Objectives of educational activities in Izu Peninsula UGGp

Overall focal points:

Implementation of local development

in terms of “sustainable development.”

Young generations

are liable to paucity of pride for hometown.

Encouragement and enhancement of pride
in terms of enrollment and future leadership in the area.

Implementation of ESD

Educational activities in Izu Peninsula UGGp

Participation in school education, 2017

Elementary school: 22 schools, 58 times

Secondary school: 5 schools, 12 times

High school: 5 schools

Teacher's training: 6 times

Public lectures 13 times

Other educational activities

Science Cafe, Civil servant training, Public workshop



Building local leadership in various sectors

Elementary school activities

Izu Peninsula is a volcanic land

Experiment base study



Volcanic eruption



Lava flow

Elementary school activities

Output

Guided tour by pupils for visitors

- Enhancement of hometown knowledge
- Encouragement pride for their hometown
- Implementation and enrollment in society



富戸小学校の子どもたちが案内します！

城ヶ崎海岸 小学生ジオツアー

大富山の噴火がつくりだした大地。その上で暮らし・学ぶ子どもたちが気づいたことをみなさまに少しでもだけお見せします。

※本ツアーは富戸小学校の総合学習の一環として行います。

2018年
2月15日(木) 9:30～ 受付開始 9:00

■集合・解散：城ヶ崎海岸（市役所）駐車場
■対象者：海岸線を歩く60分間のツアーにご参加いただける方（先着40名）
■参加費：無料
■ツアー内容：市役所（駐車場）→市役所（坂）→かんの入浜

参加者子どもたち5つのグループに分かれて30分から5分おきに出発します。最後に出発するグループは30分後ですので、出発までお待ちいただけます。あらかじめご了承ください。

お申込み・問合せ
お申込・詳細はwebサイトから！
【問合せ先】伊豆半島ジオパーク推進協議会事務局
TEL：0556-22-0228（受付時間：10～17:00）
MAIL：info@icgpa.jp
http://icgpa.jp/eng/2018/02/15/20180215MtsMtsk_tour/

アクセス
市役所（駐車場）から徒歩5分ほどです。市役所（坂）から徒歩10分ほどです。市役所（坂）から徒歩10分ほどです。市役所（坂）から徒歩10分ほどです。

主催：伊豆半島ジオパーク推進協議会



Secondary school activities

Izu Peninsula is a land of fury of natural disasters

Practice base study



Lecture



Aerial photograph interpretation practice

High school activities

Sharing and providing knowledge for various stakeholders



Geo study of hometown



Guided-tour operation



Scientific conference presentation



Teaching for elementary school students

Concept of school education

3rd gr. elementary

Pride for hometown

Area study
(Geography)

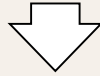

6th gr. elementary

**Basic knowledge
of the area**

Area study
(Geography)



1st gr. secondary

**Learning from
the Earth**

Science
(Geology)



3rd gr. secondary

**Learning from
Izu Peninsula**

Integrated
study

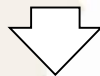

High school

**Shearing
knowledge**

Club
Activity

Community base activities (workshop)

Izu Peninsula is a land of fury of natural disasters

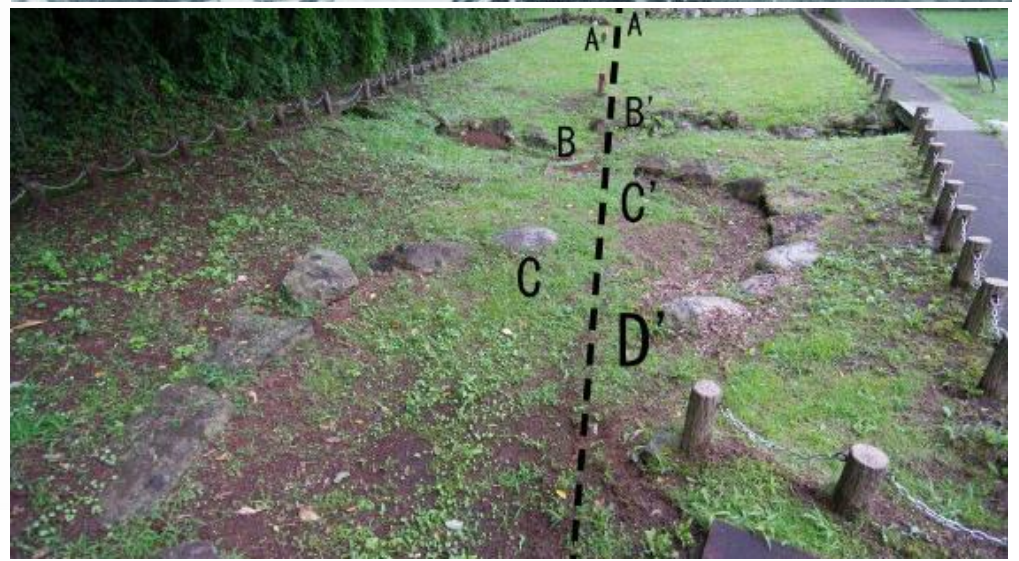

Community base activities (workshop)

Hearing the past disasters from elder residents in order to share the experience and knowledge and archive the records.



Community base activities (workshop)

Organizing workshops for compiling a hazard map to evacuate from tsunami safely



Educational activities and ESD/SDGs

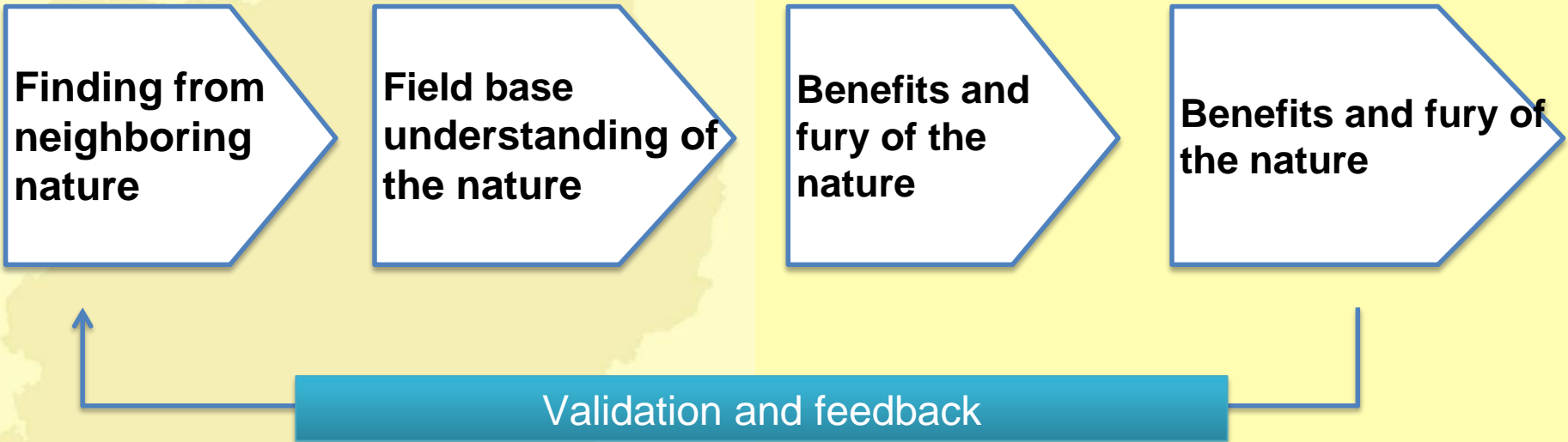

- Actual practice of Project Based Learning (PBL)
- Enhancement of solution abilities in all generations

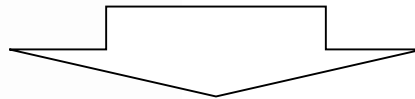

Implementation of ESD/SDGs for sustainable communities

Educational activities and SDGs in geoparks

Geopark activities are lessons for

SDGs Goal

4: Quality Education

11: Sustainable Communities

13: Climate Action



SUSTAINABLE DEVELOPMENT GOALS
17 GOALS TO TRANSFORM OUR WORLD



Summary

Educational application of geoparks

Geopark is:

Holistic concept of protection, education and sustainable development.

Development of strategies towards increasing access to education and increasing enrollment at all levels.

Giving local people a sense of pride in their hometown.

Educational activities in Izu Peninsula UGGp

Implementation of local development in terms of “sustainability.”

Geopark involvement in school education is a **practical lesson** for “sustainability.”

Implementation of ESD/SDGs for sustainable communities.

